

Basement and Enabling Works

CLIENT: **CWG (Wood Wharf Two) Limited**

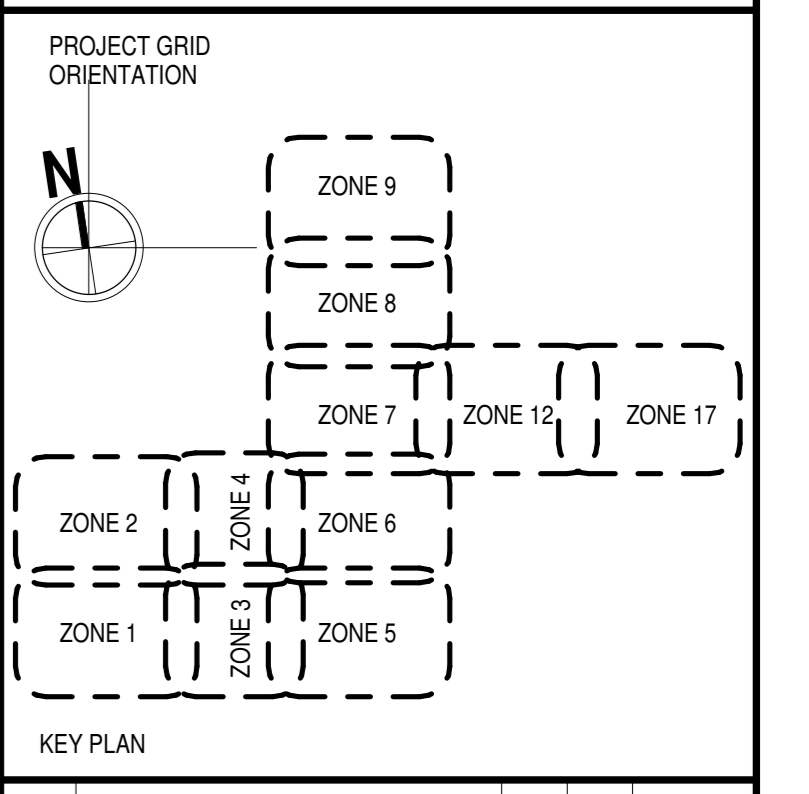

PROGRESS ISSUE

© 2016 11:03:17 PM

NO.	REASON FOR ISSUE	DRN	CHKD	DATE
REVISIONS				

Discrepancies must be reported immediately to the Architect before proceeding. Only figured dimensions are to be used. Contractors must check all dimensions on site. This drawing is protected by copyright.

ALL DIMENSIONS ARE SHOWN IN METRIC.

CONSULTANTS

GRID LAYOUT ORIENTATION PLAN

SCALE @ A0	DRAWN	CHECKED	DATE
1 : 600			
GRAPHIC SCALE			

PROJECT NO. 1414-00

DRAWING NO. **60 200**

LOCATION: 103EW REVISION: 14

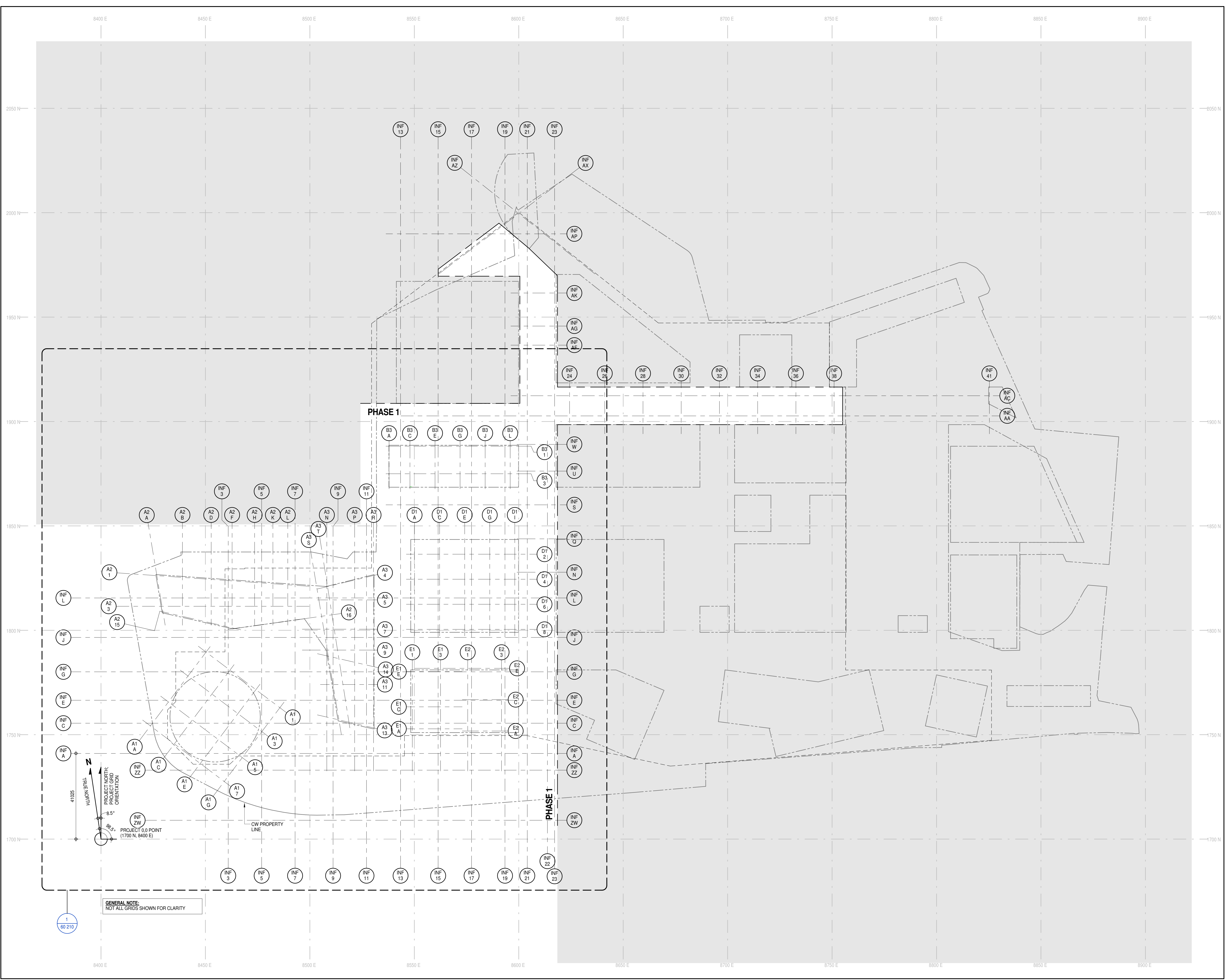

1 GRID LAYOUT ORIENTATION PLAN

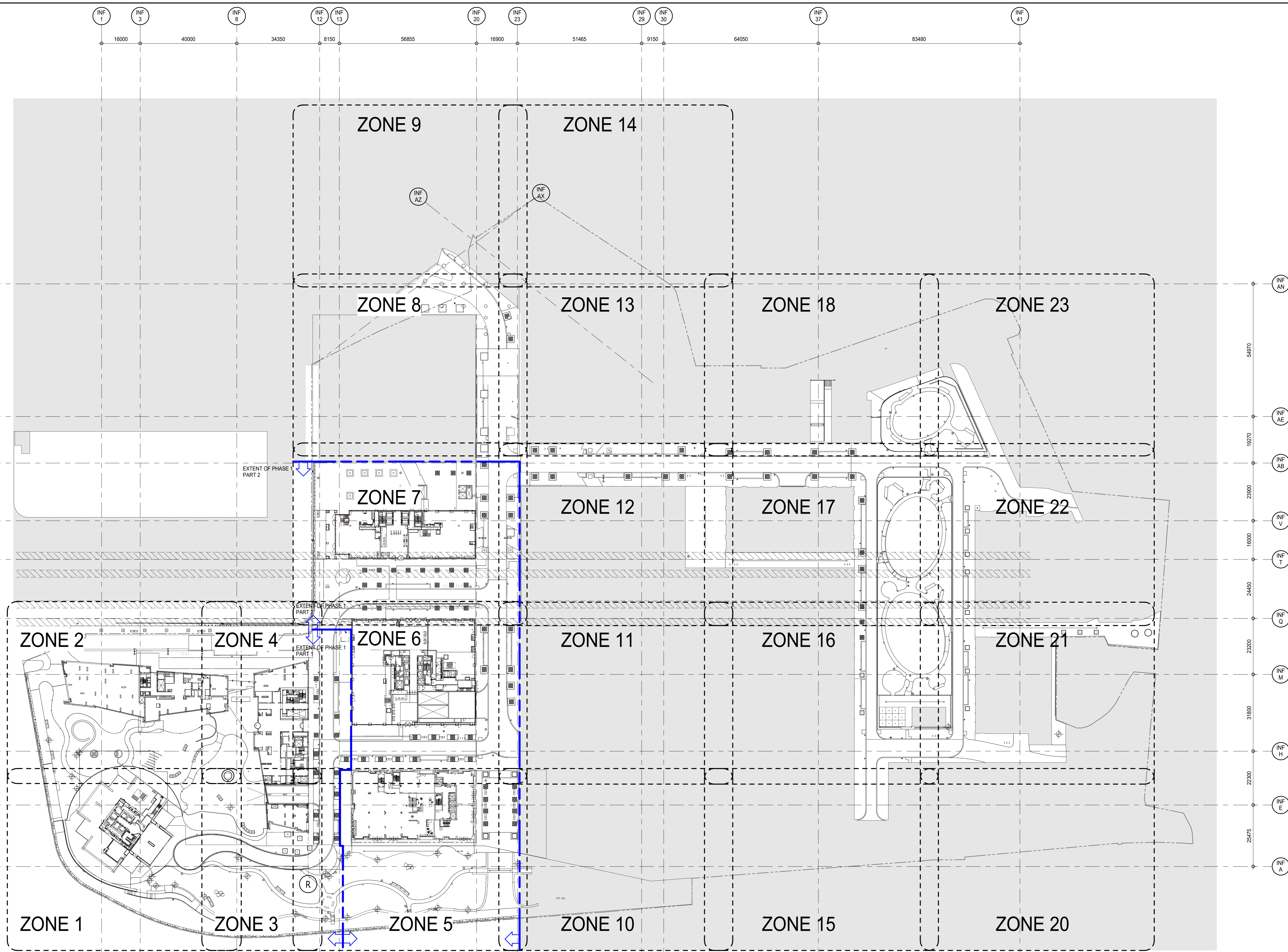

PHASE 1 REFER TO DRAWING 1 / 61 100

LEGEND:

	N.I.C.
	JUBILEE LINE CLEARANCE ZONE
	EXTENT OF ROAD BOX AT DOUBLE HEIGHT SPACE
	EXTENT OF DOUBLE HEIGHT SPACE
	NOT EXCAVATED
	CONCRETE PAD; REFER TO MEP DRAWINGS

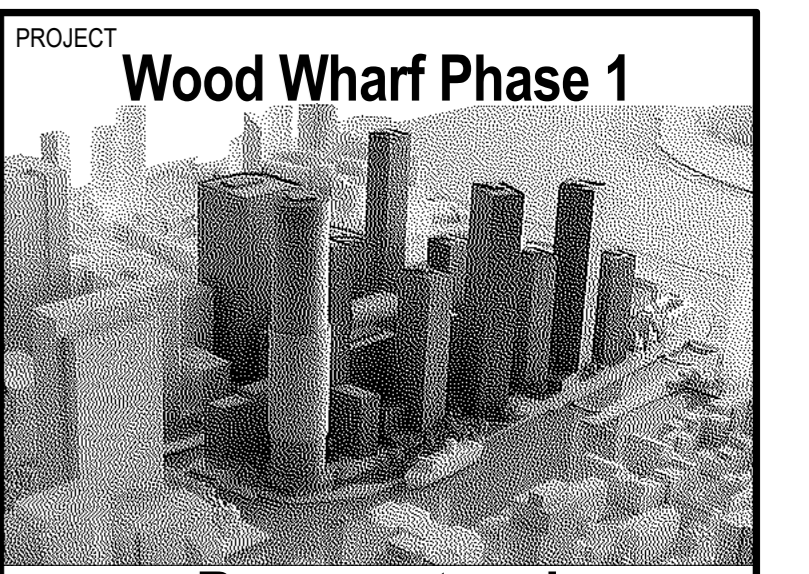

Basement and Enabling Works

CLIENT: **CWG (Wood Wharf Two) Limited**

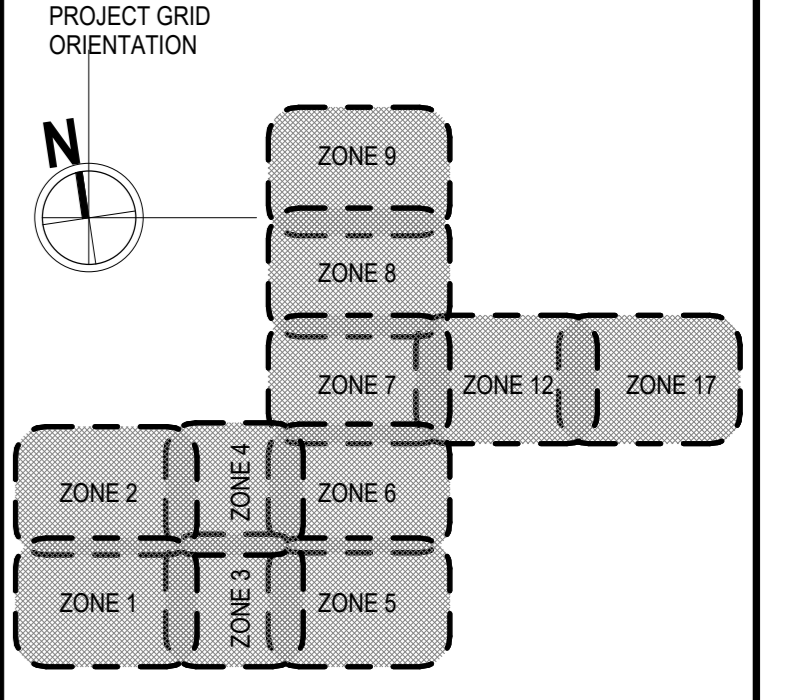

PROGRESS ISSUE
 05/2016 10:12 AM

NO.	REASON FOR ISSUE	DRN	CHKD	DATE
REVISIONS				
Discrepancies must be reported immediately to the Architect before proceeding. Only figured dimensions are to be used. Contractors must check all dimensions on site. This drawing is protected by copyright.				
ALL DIMENSIONS ARE SHOWN IN METRIC.				

CONSULTANTS

SITE PLAN

SCALE @ A0	DRAWN	CHECKED	DATE
1 : 600			
GRAPHIC SCALE			
PROJECT NO.	1414-00		
DRAWING NO.	60 300		
LOCATION	103EW	REVISION	15

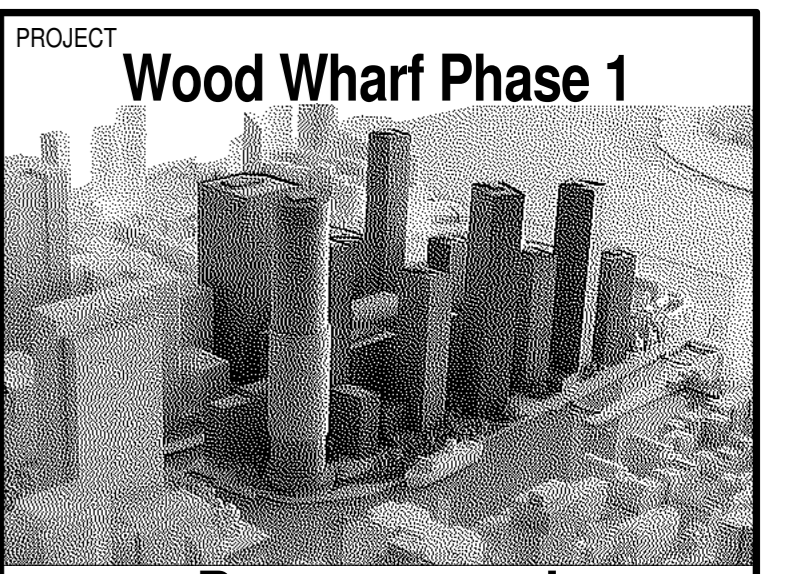

Basement and Enabling Works

CLIENT: **CWG (Wood Wharf Two) Limited**

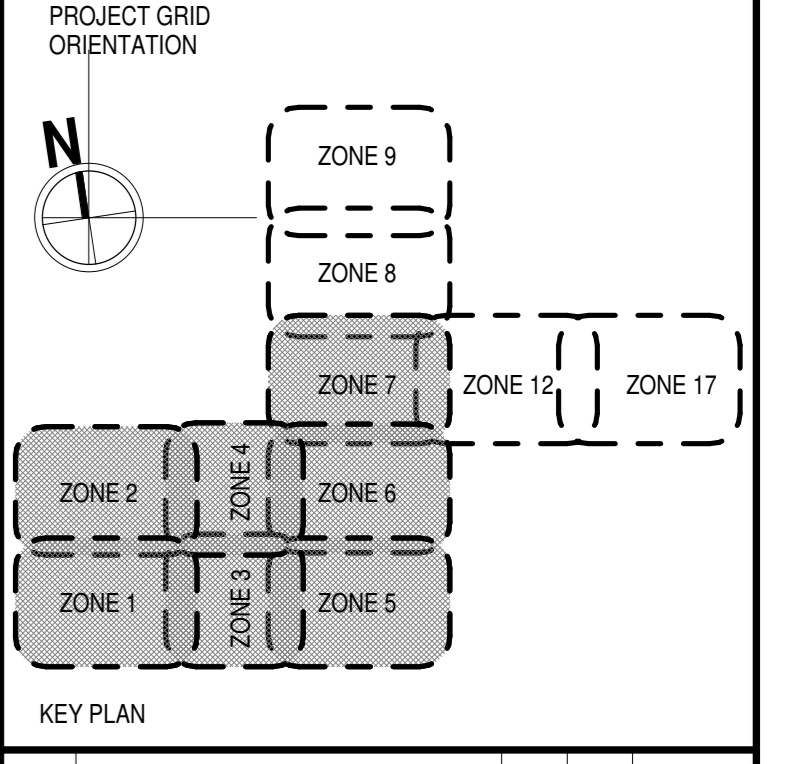

NO. REASON FOR ISSUE DRN CHNG DATE

REVISIONS

Discrepancies must be reported immediately to the Architect before proceeding. Only figured dimensions are to be used. Contractors must check all dimensions on site. This drawing is protected by copyright.

ALL DIMENSIONS ARE SHOWN IN METRIC.

CONSULTANTS

DRAWING TITLE

PHASE 1 - GROUND LEVEL FLOOR PLAN

SCALE @ A0 DRAWN CHECKED DATE

1 : 300

GRAPHIC SCALE 0 5 10 15m

PROJECT NO. 1414-00

DRAWING NO. **61 100**

LOCATION 103EW REVISION 13

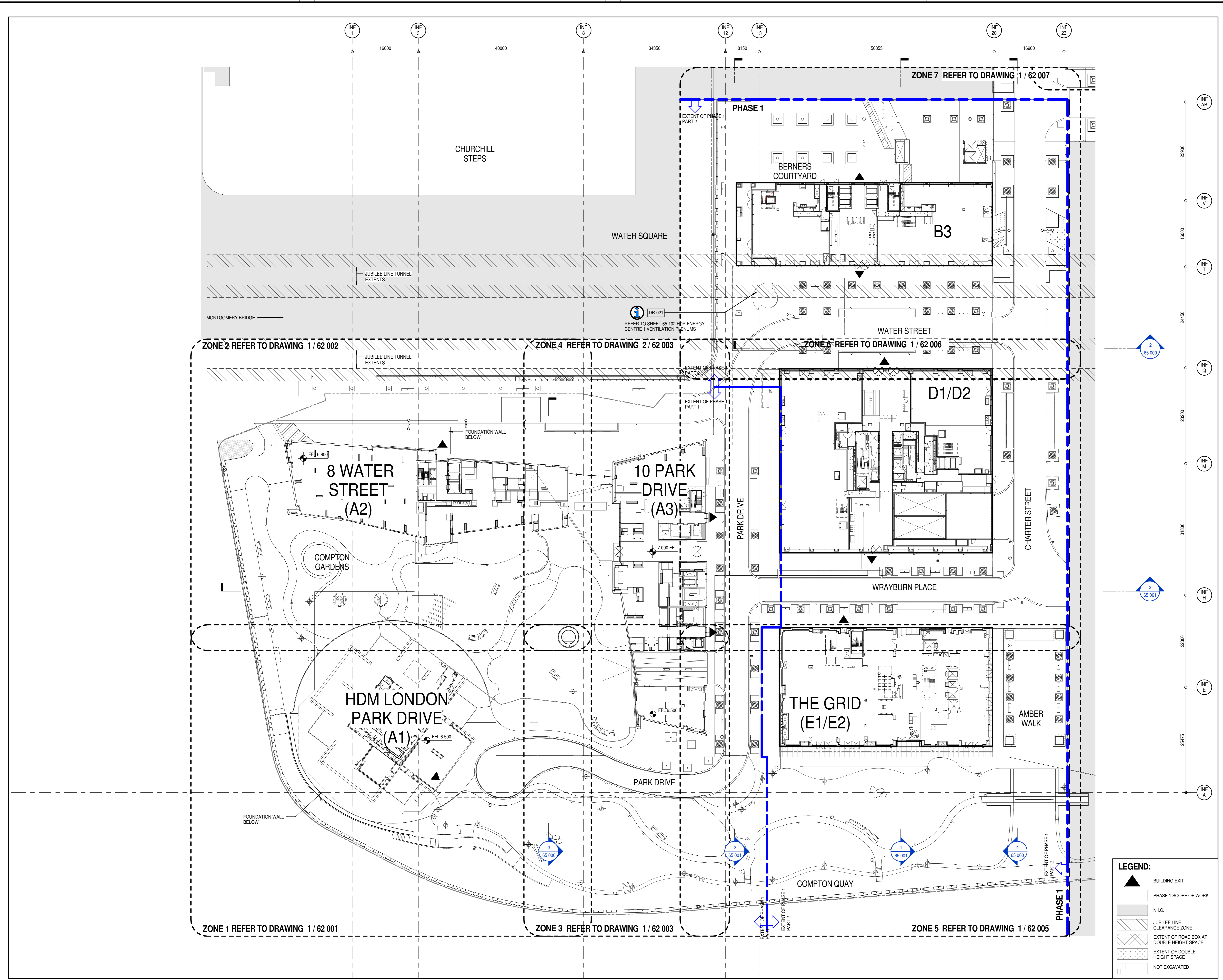

LEGEND:

- BUILDING EXIT
- PHASE 1 SCOPE OF WORK
- N.I.C.
- JUBILEE LINE CLEARANCE ZONE
- EXTENT OF ROAD BOX AT DOUBLE HEIGHT SPACE
- EXTENT OF DOUBLE HEIGHT SPACE
- NOT EXCAVATED

1 PHASE 1-GROUND LEVEL FLOOR PLAN
1:300

6/2/2016 1:00:25 PM

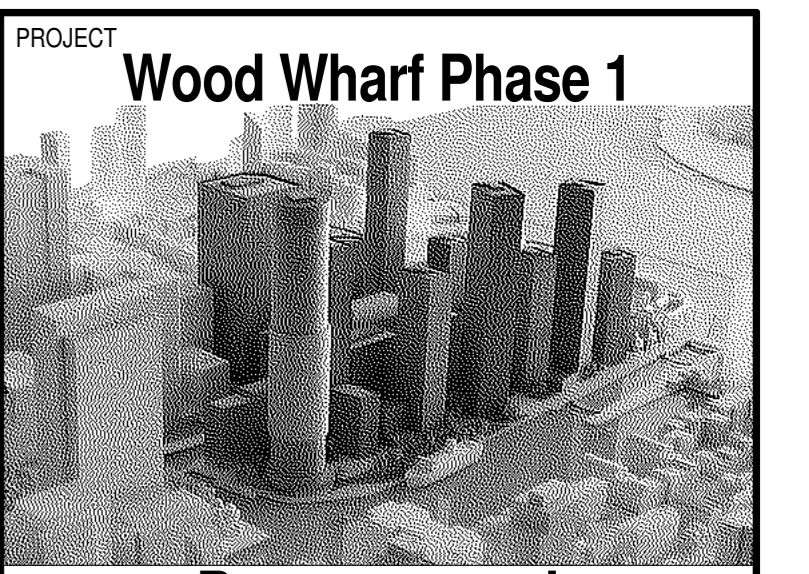

Basement and Enabling Works

CLIENT: **CWG (Wood Wharf Two) Limited**

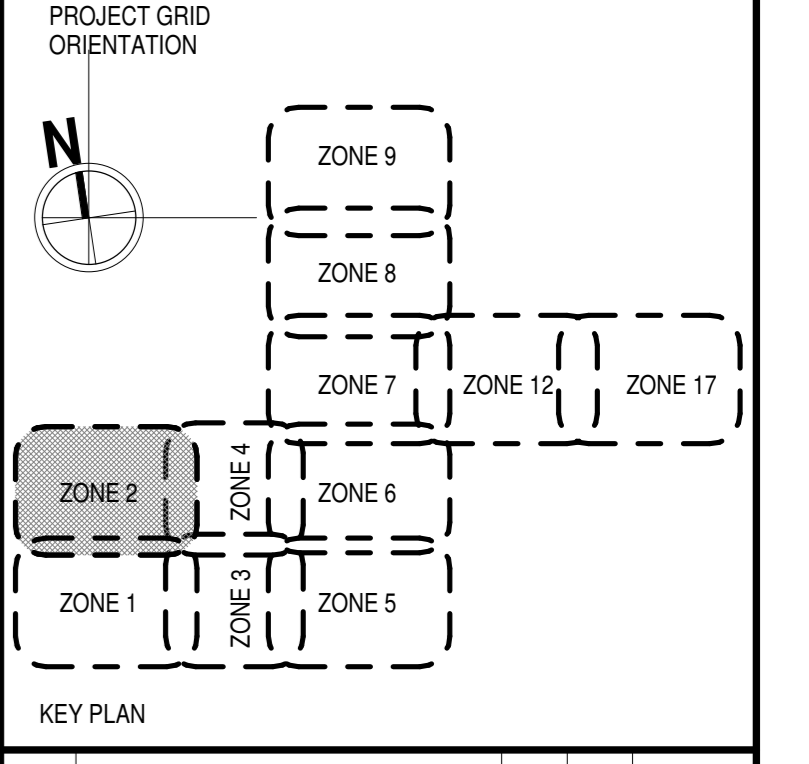

REVISIONS

NO.	REASON FOR ISSUE	DRN	CHKD	DATE
11	ISSUED FOR ADDENDUM 1 - BLOCKWORK/METAL DOORS	MG	PM	29 APR 2016
10	ISSUED FOR TENDER - BLOCKWORK/METAL DOORS	MG	PM	26 FEB 2016
09	SUPERSEDES DRAWING 62026	MG	PM	08 FEB 2016
08	ISSUED FOR DRAFT TENDER (T1)	MG	PM	05 FEB 2016
07	PHASE 1 PART 2 DD2 ISSUE	MG	PM	11 DEC 2015
06	FINAL TENDER ISSUE (T2) - A2A3 SUBSTRUCTURE	MG	PM	11 SEP 2015
05	DRAFT TENDER ISSUE (T1) - A2A3 SUBSTRUCTURE	MG	PM	21 AUG 2015
04	ISSUED FOR A2A3 SUBSTRUCTURE GA FREEZE	MG	PM	14 AUG 2015
03	ISSUED FOR TENDER (T2)	MG	PM	03 JUL 2015
02	FINAL TENDER ISSUE (T2) - A1 CONCRETE / A2A3 RAFT SLAB	MG	PM	19 JUN 2015
01	DRAFT TENDER ISSUE (T1) - A1 CONCRETE / A2A3 RAFT SLAB	BB	PM	29 MAY 2015
00	ZONE 'A' GA FREEZE	MG	PM	10 APR 2015

DISCREPANCIES

Discrepancies must be reported immediately to the Architect before proceeding. Only figured dimensions are to be used. Contractors must check all dimensions on site. This drawing is protected by copyright.

ALL DIMENSIONS ARE SHOWN IN METRIC.

CONSULTANTS

Masterplan Architects	Allies and Morrison 85 Southwark Street London, SE1 0HX
Basement Architects	Adamson Associates 401 Wellington St. W. Toronto, M5V 1E7
Structural Engineers	Ramboll 60 Newman Street London, W1T 3DA
Infrastructure MEP	AECOM Mid City Place 71 High Holborn London, WC1V 6QS
Logistic & Transport	Steer Davies Gleave 25-32 Upper Ground London, SE1 9PD
Fire and Life Safety	ARUP 13 Fitzroy Street London, W1T 4BQ

REVISIONS

NO.	REASON FOR ISSUE	DRN	CHKD	DATE
1	ISSUED FOR ADDENDUM 1 - BLOCKWORK/METAL DOORS	MG	PM	29 APR 2016



DRAWING TITLE
B1 LEVEL ZONE 02 FLOOR PLAN

SCALE @ A0	DRAWN	CHECKED	DATE
1:100	MG	PM	06 FEB 2015

GRAPHIC SCALE: 0 1 2 4 6m

PROJECT NO. 1414-00

DRAWING NO. **62 102**

LOCATION: 103EW REVISION: 11

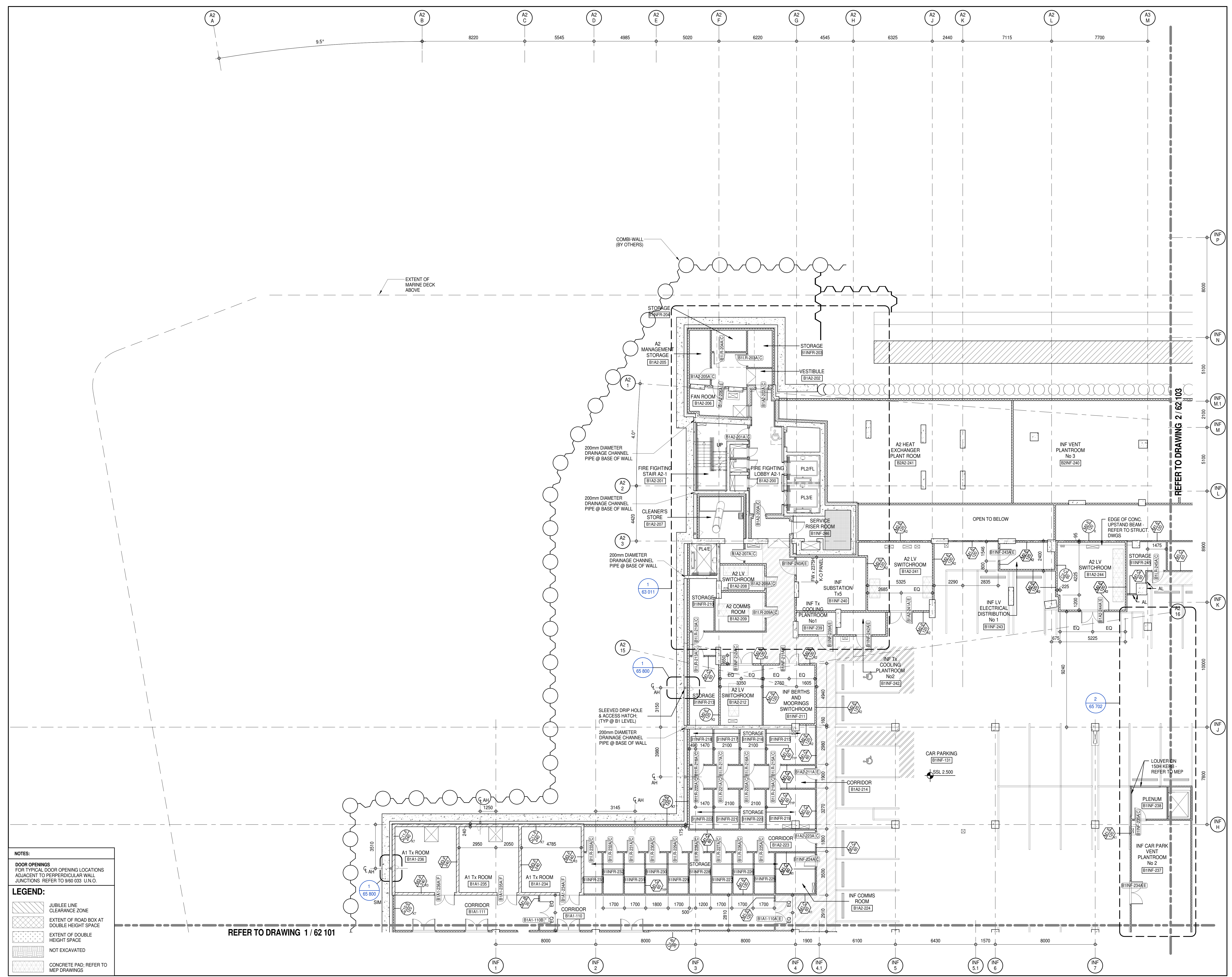

NOTES:

DOOR OPENINGS FOR TYPICAL DOOR OPENING LOCATIONS ADJACENT TO PERPENDICULAR WALL JUNCTIONS REFER TO S190.003 U.N.C.

LEGEND:

- JUBILEE LINE CLEARANCE ZONE
- EXTENT OF ROAD BOX AT DOUBLE HEIGHT SPACE
- EXTENT OF DOUBLE HEIGHT SPACE
- NOT EXCAVATED
- CONCRETE PAD; REFER TO MEP DRAWINGS

1 B1 LEVEL ZONE 02 FLOOR PLAN
1:100

6/2/2016 12:51:18 PM



Basement and Enabling Works

CLIENT CWG (Wood Wharf Two) Limited

PROJECT GRID ORIENTATION

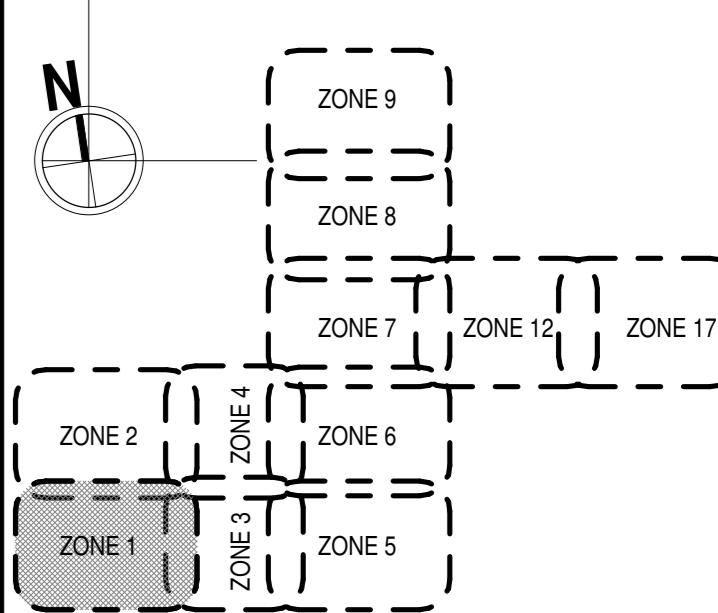

KEY PLAN

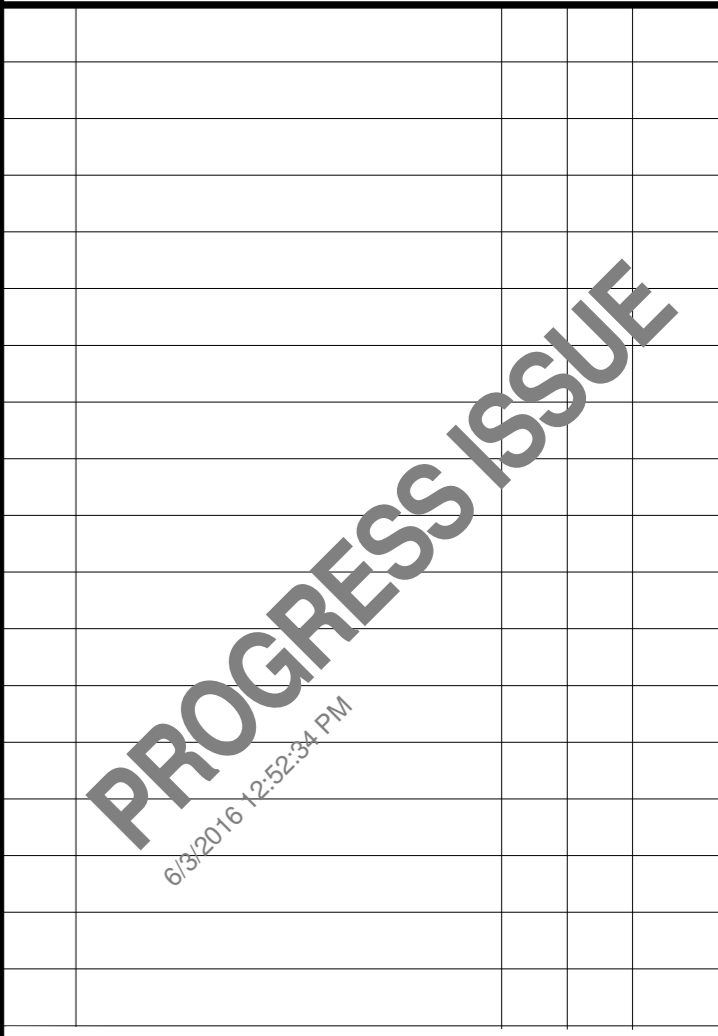

NO.	REASON FOR ISSUE	DRN	CHKD	DATE
REVISIONS				
Discrepancies must be reported immediately to the Architect before proceeding. Only figured dimensions are to be used. Contractors must check all dimensions on site. This drawing is protected by copyright.				
ALL DIMENSIONS ARE SHOWN IN METRIC.				

CONSULTANTS

DRAWING TITLE
B2 LEVEL ZONE 01 FLOOR PLAN

SCALE @ A0	DRAWN	CHECKED	DATE
As indicated			
GRAPHIC SCALE 0 1 2 4 6m			

PROJECT NO.
1414-00

DRAWING NO.
62 201

LOCATION 103EW REVISION 12

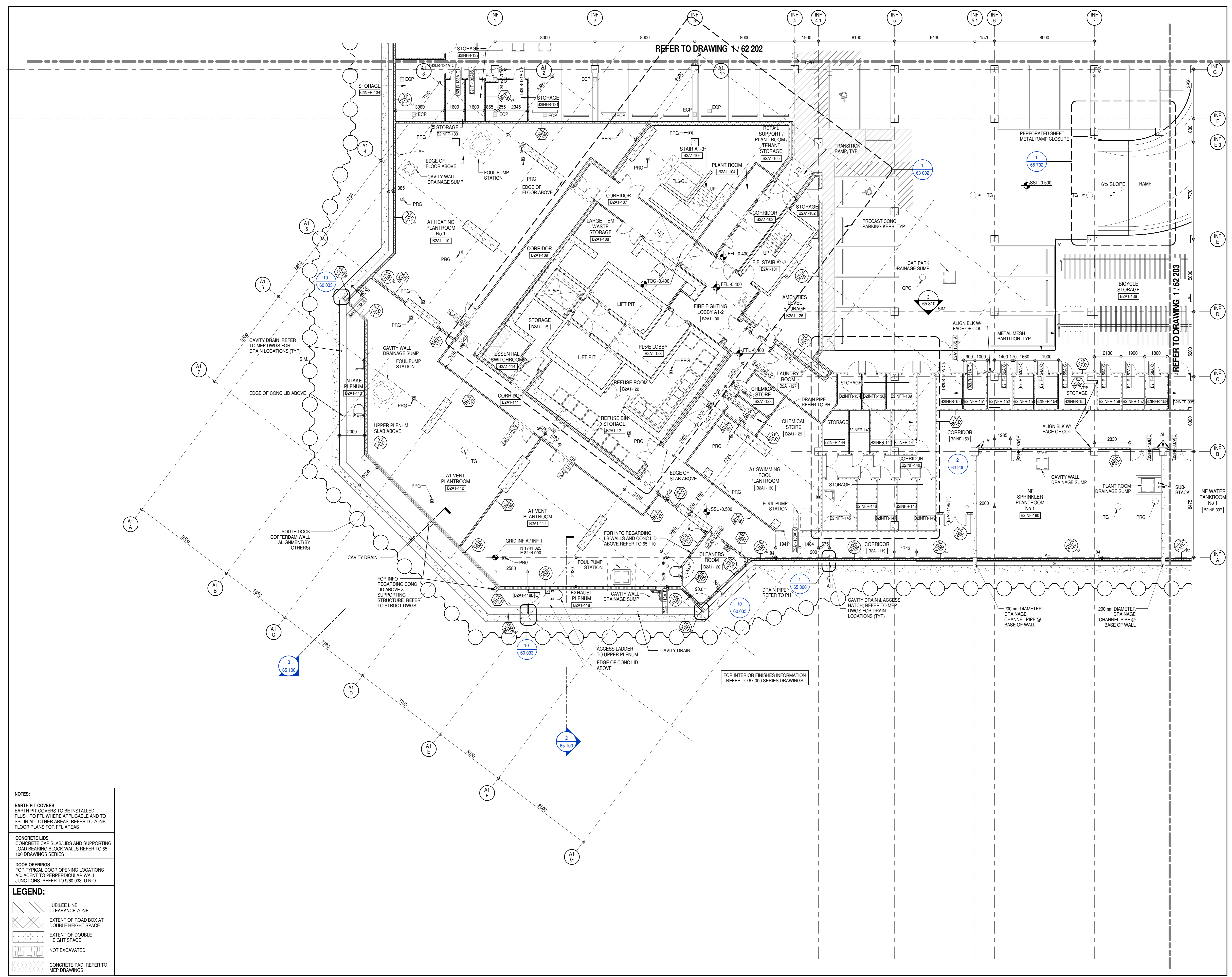

REFER TO DRAWING 1 / 62 202

REFER TO DRAWING 1 / 62 203

FOR INTERIOR FINISHES INFORMATION REFER TO 67 000 SERIES DRAWINGS

- NOTES:**
- EARTH PIT COVERS**
EARTH PIT COVERS TO BE INSTALLED FLUSH TO FFL WHERE APPLICABLE AND TO SSL IN ALL OTHER AREAS. REFER TO ZONE FLOOR PLANS FOR FFL AREAS
 - CONCRETE LIDS**
CONCRETE CAP SLABLIDS AND SUPPORTING LOAD BEARING BLOCK WALLS REFER TO 65 100 DRAWINGS SERIES
 - DOOR OPENINGS**
FOR TYPICAL DOOR OPENING LOCATIONS ADJACENT TO PERPENDICULAR WALL JUNCTIONS REFER TO 65 003 U.N.O.
- LEGEND:**
- JUBILEE LINE CLEARANCE ZONE
 - EXTENT OF ROAD BOX AT DOUBLE HEIGHT SPACE
 - EXTENT OF DOUBLE HEIGHT SPACE
 - NOT EXCAVATED
 - CONCRETE PAD; REFER TO MEP DRAWINGS

1 B2 LEVEL ZONE 01 FLOOR PLAN

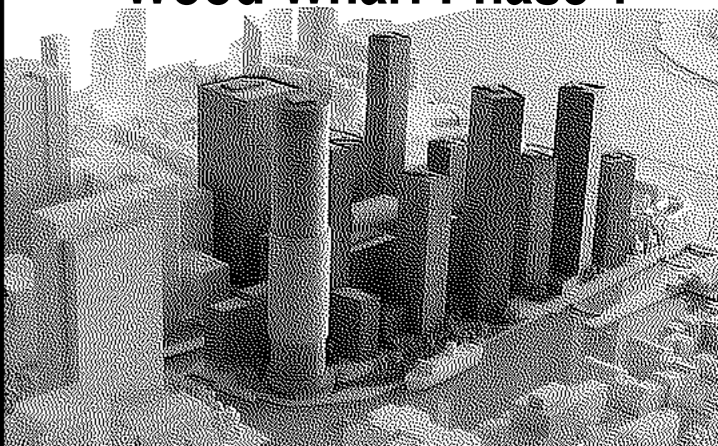

Basement and Enabling Works

CLIENT CWG (Wood Wharf Two) Limited

PROJECT GRID ORIENTATION

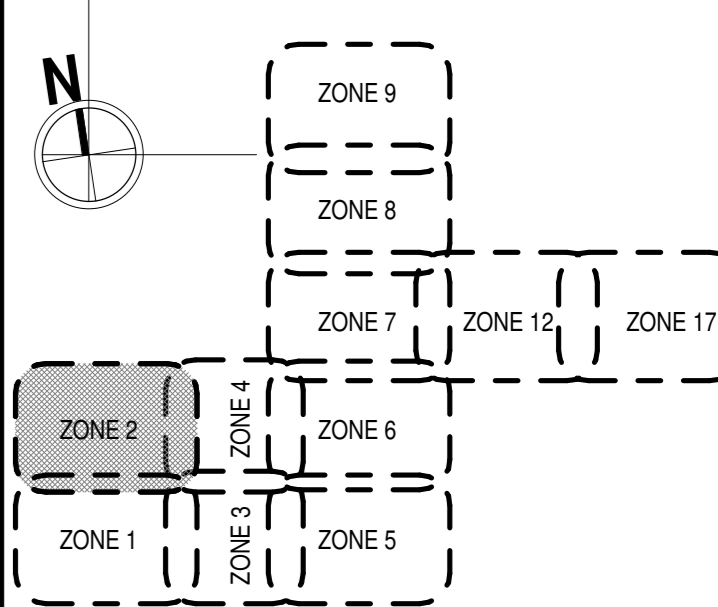

KEY PLAN

NO.	REASON FOR ISSUE	DRN	CHKD	DATE
REVISIONS				
Discrepancies must be reported immediately to the Architect before proceeding. Only figured dimensions are to be used. Contractors must check all dimensions on site. This drawing is protected by copyright.				
ALL DIMENSIONS ARE SHOWN IN METRIC.				
CONSULTANTS				

PROGRESS ISSUE
05/20/2016 12:52:44 PM

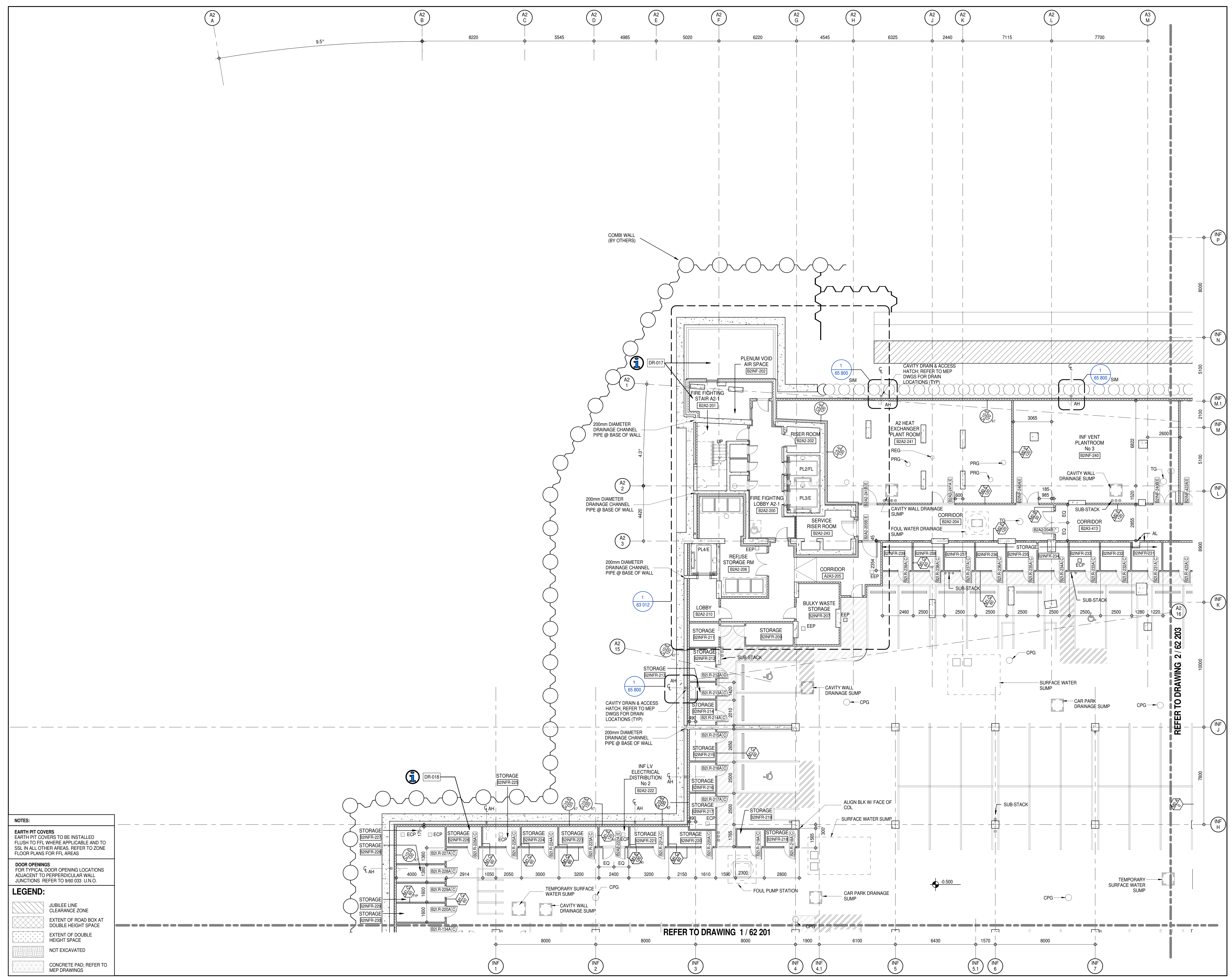

- NOTES:**
- EARTH PIT COVERS: EARTH PIT COVERS TO BE INSTALLED FLUSH TO FFL WHERE APPLICABLE AND TO SSL IN ALL OTHER AREAS. REFER TO ZONE FLOOR PLANS FOR FFL AREAS
 - DOOR OPENINGS: FOR TYPICAL DOOR OPENING LOCATIONS ADJACENT TO PERPENDICULAR WALL JUNCTIONS. REFER TO S190.033 U.N.O.
- LEGEND:**
- JUBILEE LINE CLEARANCE ZONE
 - EXTENT OF ROAD BOX AT DOUBLE HEIGHT SPACE
 - EXTENT OF DOUBLE HEIGHT SPACE
 - NOT EXCAVATED
 - CONCRETE PAD; REFER TO MEP DRAWINGS

1 B2 LEVEL ZONE 02 FLOOR PLAN
1:100

REFER TO DRAWING 2 62 203

REFER TO DRAWING 1 62 201

DRAWING TITLE
B2 LEVEL ZONE 02 FLOOR PLAN

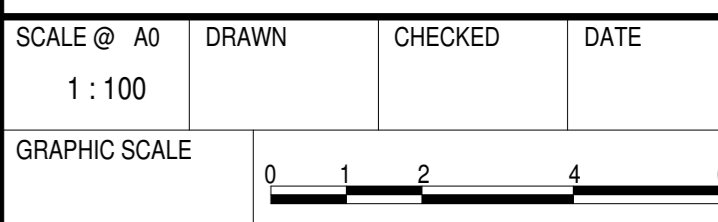

PROJECT NO. 1414-00

DRAWING NO. 62 202

LOCATION 103EW REVISION 11

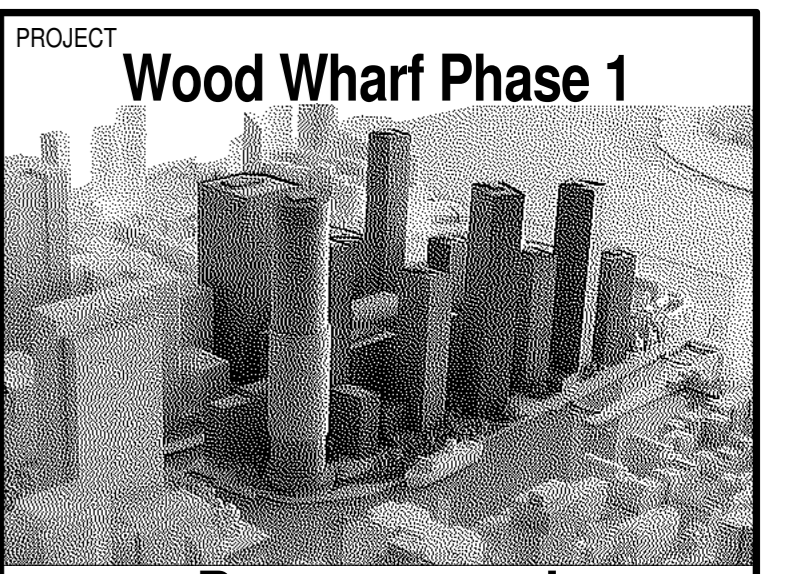

Basement and Enabling Works

CLIENT: **CWG (Wood Wharf Two) Limited**

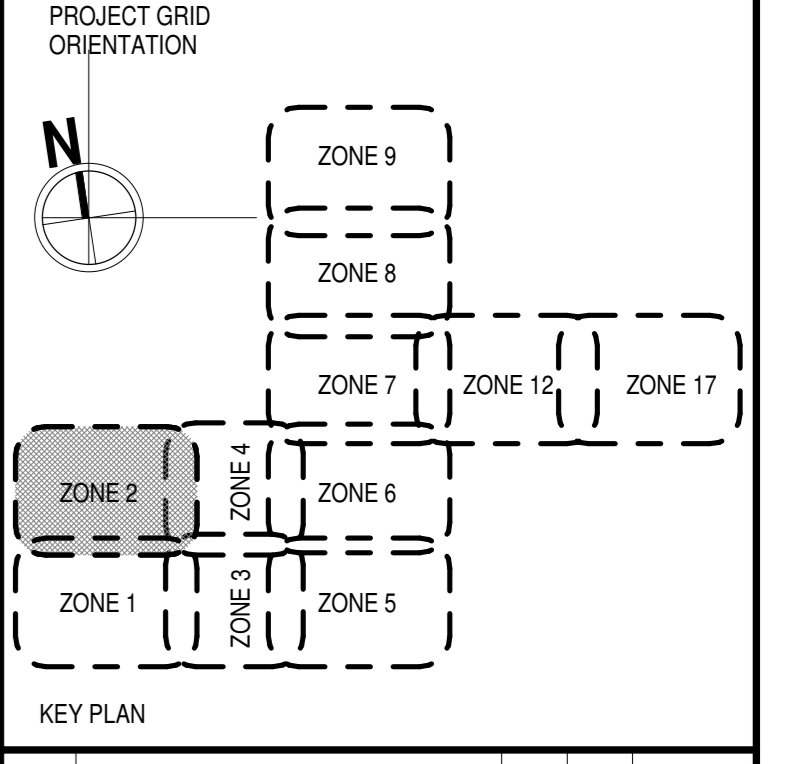

REVISIONS

NO.	REASON FOR ISSUE	DRN	CHKD	DATE
09	ISSUED FOR ADDENDUM 1 - BLOCKWORK METAL DOORS	BM.L	PM	29 APR 2016
08	ISSUED FOR TENDER	BM.L	PM	26 FEB 2016
07	SUPERSEDES DRAWING 62151	BM.L	PM	08 FEB 2016
06	ISSUED FOR DRAFT TENDER (T1)	BM.L	PM	05 FEB 2016
05	ISSUED FOR CONSTRUCTION	BM.L	PM	18 DEC 2015
04	PHASE 1 PART 2 O&E ISSUE	BM.L	PM	11 DEC 2015
03	FINAL TENDER ISSUE (T2) - AZA3 SUBSTRUCTURE	BM.L	PM	21 SEP 2015
02	DRAFT TENDER ISSUE (T1) - AZA3 SUBSTRUCTURE	MG	PM	21 AUG 2015
01	ISSUED FOR AZA3 SUBSTRUCTURE	MG	PM	14 AUG 2015
00	GA FREEZE	MG	PM	10 APR 2015

DISCREPANCIES

Discrepancies must be reported immediately to the Architect before proceeding. Only figured dimensions are to be used. Contractors must check all dimensions on site. This drawing is protected by copyright.

ALL DIMENSIONS ARE SHOWN IN METRIC.

CONSULTANTS

- Masterplan Architects**: Allies and Morrison, 85 Southwark Street, London, SE1 0HX
- Basement Architects**: Adamson Associates, 401 Wellington St., W., Toronto, M5V 1E7
- Structural Engineers**: Ramboll, 60 Newman Street, London, W1T 3DA
- Infrastructure MEP**: AECOM, Mid City Place, 71 High Holborn, London, WC1V 6QS
- Logistic & Transport**: Steer Davies Gleave, 25-32 Upper Ground, London, SE1 9PD
- Fire and Life Safety**: ARUP, 13 Fitzroy Street, London, W1T 4BQ



DRAWING TITLE

B1 LEVEL ZONE 02 SLAB EDGE PLAN

SCALE @	DRAWN	CHECKED	DATE
1:100	MG	PM	06 FEB 2015

GRAPHIC SCALE: 0 1 2 4 6m

PROJECT NO: 1414-00

DRAWING NO: **62 602**

LOCATION: 103EW REVISION: 09

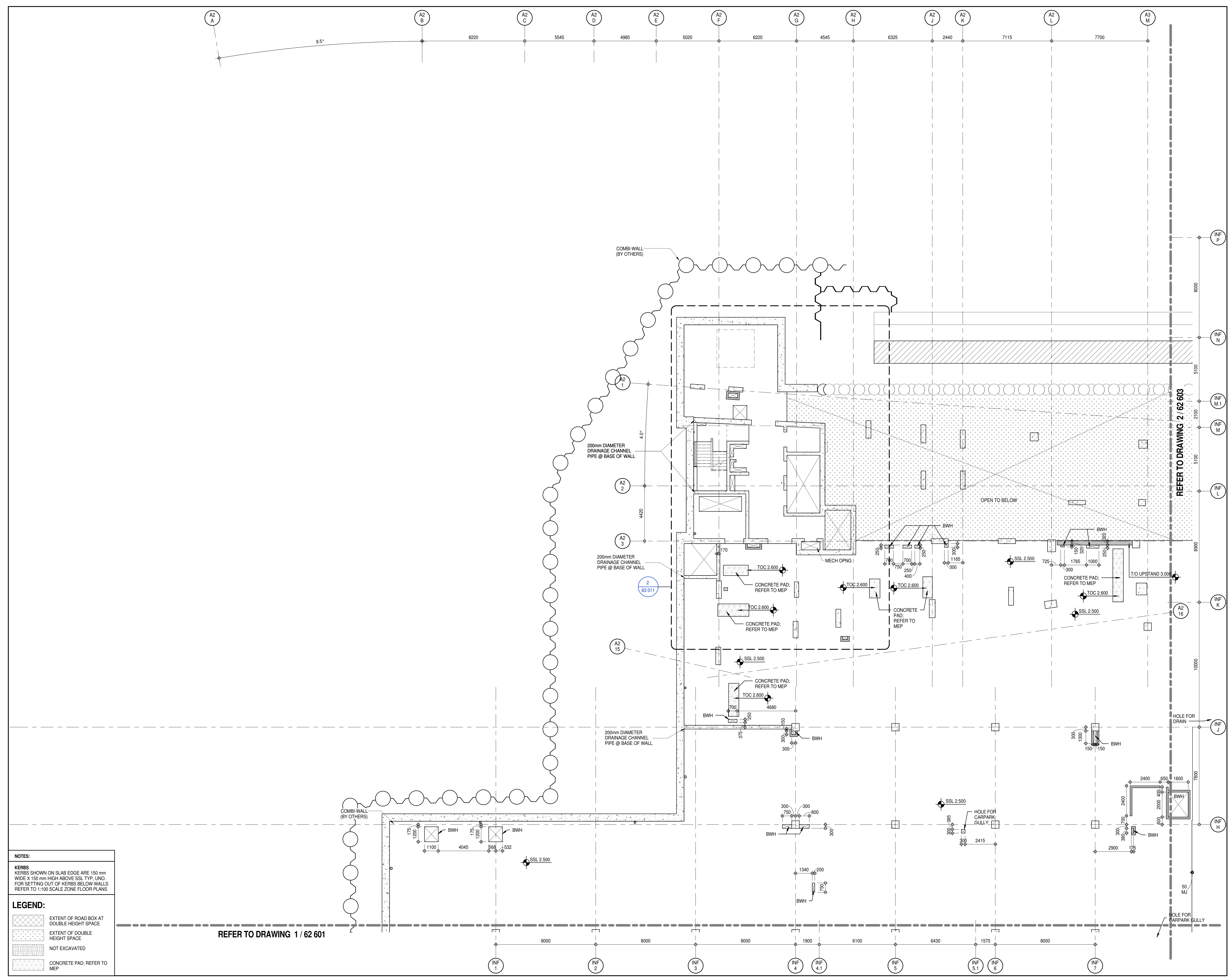

NOTES:

KERBS SHOWN ON SLAB EDGE ARE 150 mm WIDE X 150 mm HIGH ABOVE SSL TYP. UNO. FOR SETTING OUT OF KERBS BELOW WALLS REFER TO 1:100 SCALE ZONE FLOOR PLANS

LEGEND:

- EXTENT OF ROAD BOX AT DOUBLE HEIGHT SPACE
- EXTENT OF DOUBLE HEIGHT SPACE
- NOT EXCAVATED
- CONCRETE PAD; REFER TO MEP

1 B1 LEVEL ZONE 02 SLAB EDGE PLAN

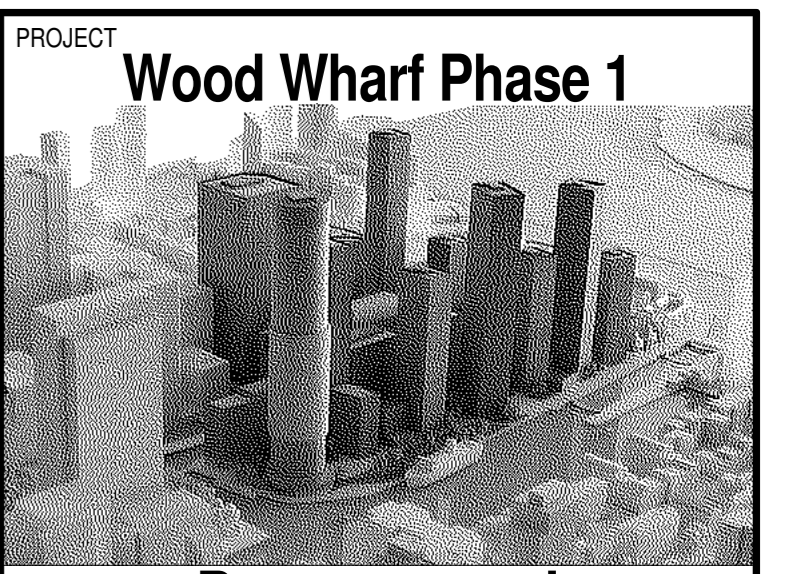

Basement and Enabling Works

CLIENT: **CWG (Wood Wharf Two) Limited**

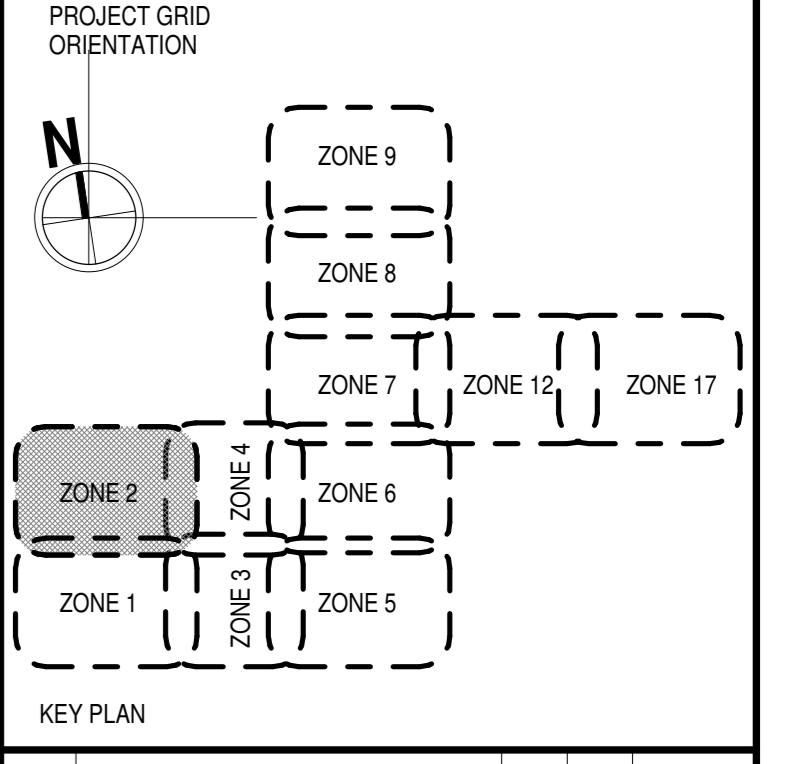

KEY PLAN

13	ISSUED FOR ADDENDUM 1 - BLOCKWORK/METAL DOORS	BM.L	PM	29 APR 2016
12	ISSUED FOR TENDER - BLOCKWORK/METAL DOORS	BM.L	PM	26 FEB 2016
11	SUPERSEDES DRAWING 62176	BM.L	PM	06 FEB 2016
10	ISSUED FOR DRAFT TENDER (T1)	BM.L	PM	06 FEB 2016
09	ISSUED FOR CONSTRUCTION	BM.L	PM	18 DEC 2015
08	PHASE 1 PART 2 DD2 ISSUE	BM.L	PM	11 DEC 2015
07	ISSUED FOR CONSTRUCTION	BM.L	PM	20 NOV 2015
06	FINAL TENDER ISSUE (T2) - A2A3 SUBSTRUCTURE	BM.L	PM	11 SEP 2015
05	DRAFT TENDER ISSUE (T1) - A2A3 SUBSTRUCTURE	MG	PM	21 AUG 2015
04	ISSUED FOR A2A3 SUBSTRUCTURE GA FREEZE	MG	PM	14 AUG 2015
03	ISSUED FOR TENDER (T2)	MG	PM	03 JUL 2015
02	FINAL TENDER ISSUE (T2) - A1 CONCRETE / A2A3 RAFT SLAB	MG	PM	19 JUN 2015
01	DRAFT TENDER ISSUE (T1) - A1 CONCRETE / A2A3 RAFT SLAB	BB	PM	29 MAY 2015
00	ZONE 'A' GA FREEZE	SN	PM	10 APR 2015

REVISIONS

NO.	REASON FOR ISSUE	DRN	CHKD	DATE

Discrepancies must be reported immediately to the Architect before proceeding. Only figured dimensions are to be used. Contractors must check all dimensions on site. This drawing is protected by copyright.

CONSULTANTS

Masterplan Architects	Allies and Morrison 85 Southwark Street London, SE1 0HX
Basement Architects	Adamson Associates 401 Wellington St., W. Toronto, M5V 1E7
Structural Engineers	Ramboll 60 Newmarket Street London, W1T 3DA
Infrastructure MEP	AECOM Mid City Place 71 High Holborn London, WC1V 6QS
Logistic & Transport	Steer Davies Gleave 25-30 Upper Ground London, SE1 9PD
Fire and Life Safety	ARUP 13 Fitzroy Street London, W1T 4BQ



DRAWING TITLE
B2 LEVEL ZONE 02 SLAB EDGE PLAN

SCALE @ A0	DRAWN	CHECKED	DATE
1:100	MG	PM	06 FEB 2015

GRAPHIC SCALE: 0 1 2 4 6m

PROJECT NO. 1414-00

DRAWING NO. **62 702**

LOCATION 103EW REVISION 13

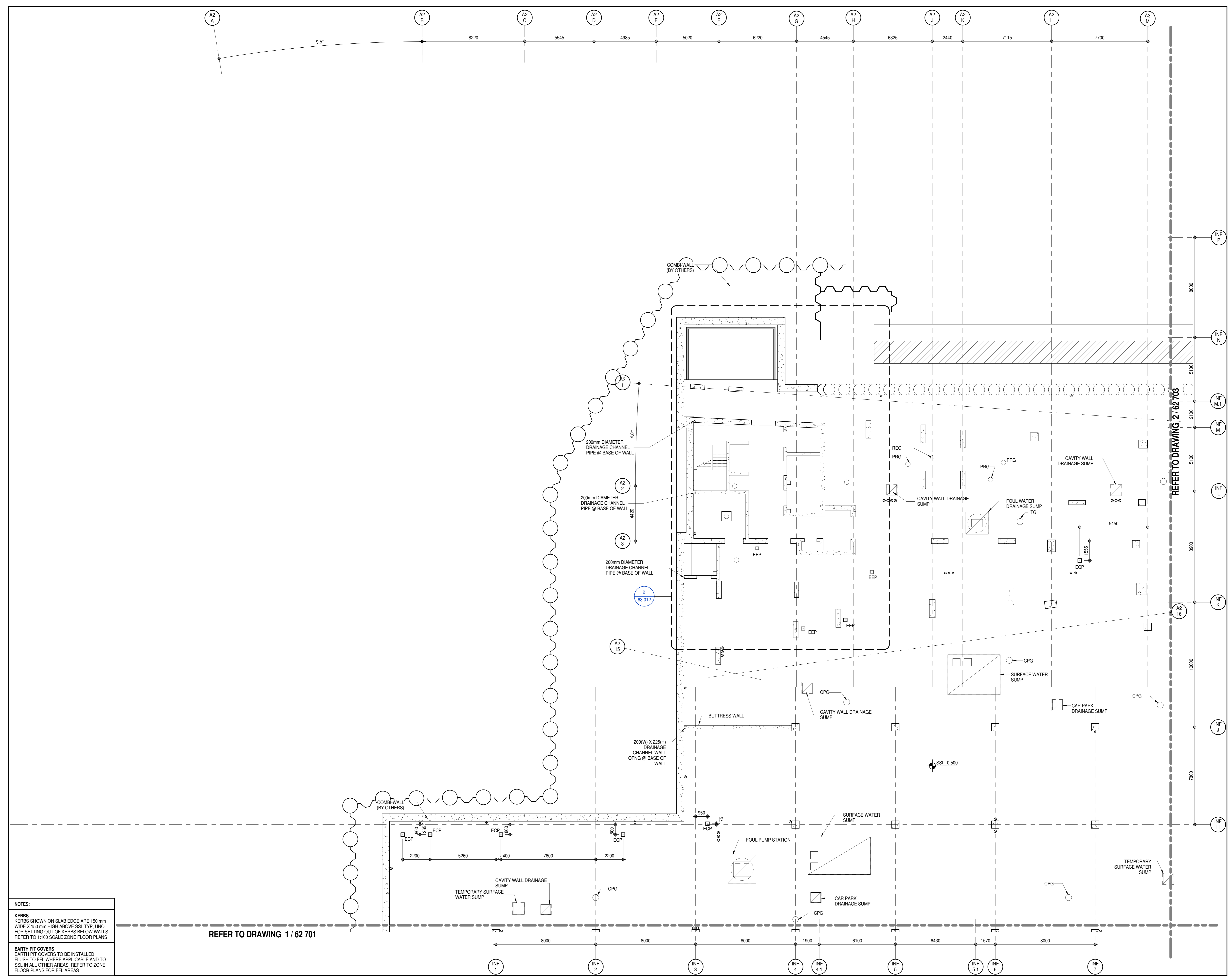

NOTES:

KERBS
KERBS SHOWN ON SLAB EDGE ARE 150 mm WIDE X 150 mm HIGH ABOVE SSL TYP. UNO. FOR SETTING OUT OF KERBS BELOW WALLS REFER TO 1:100 SCALE ZONE FLOOR PLANS

EARTH PIT COVERS
EARTH PIT COVERS TO BE INSTALLED FLUSH TO FFL WHERE APPLICABLE AND TO SSL IN ALL OTHER AREAS. REFER TO ZONE FLOOR PLANS FOR FFL AREAS

1 B2 LEVEL ZONE 02 SLAB EDGE PLAN
1:100

6/2/2016 12:57:06 PM

Wood Wharf Phase 1

Basement and Enabling and

CLIENT: **CWG (Wood Wharf Two) Limited**

PROJECT GRID ORIENTATION:

KEY PLAN

PROGRESS ISSUE

© 2016 BSA 12-11-17 PM

NO.	REASON FOR ISSUE	DRN	CHKD	DATE
REVISIONS				
Discrepancies must be reported immediately to the Architect before proceeding. Only figured dimensions are to be used. Contractors must check all dimensions on site. This drawing is protected by copyright.				
ALL DIMENSIONS ARE SHOWN IN METRIC.				
CONSULTANTS				

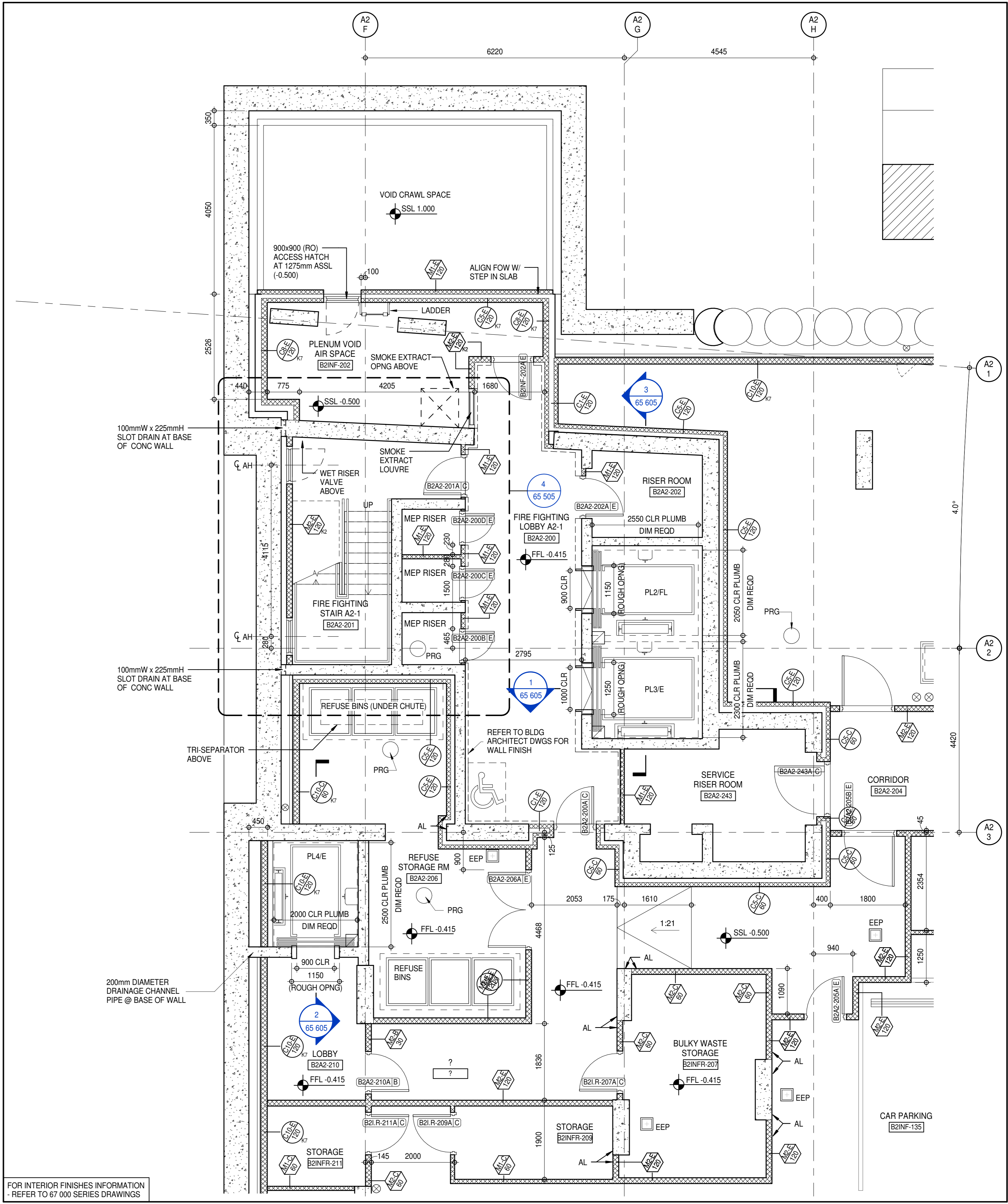
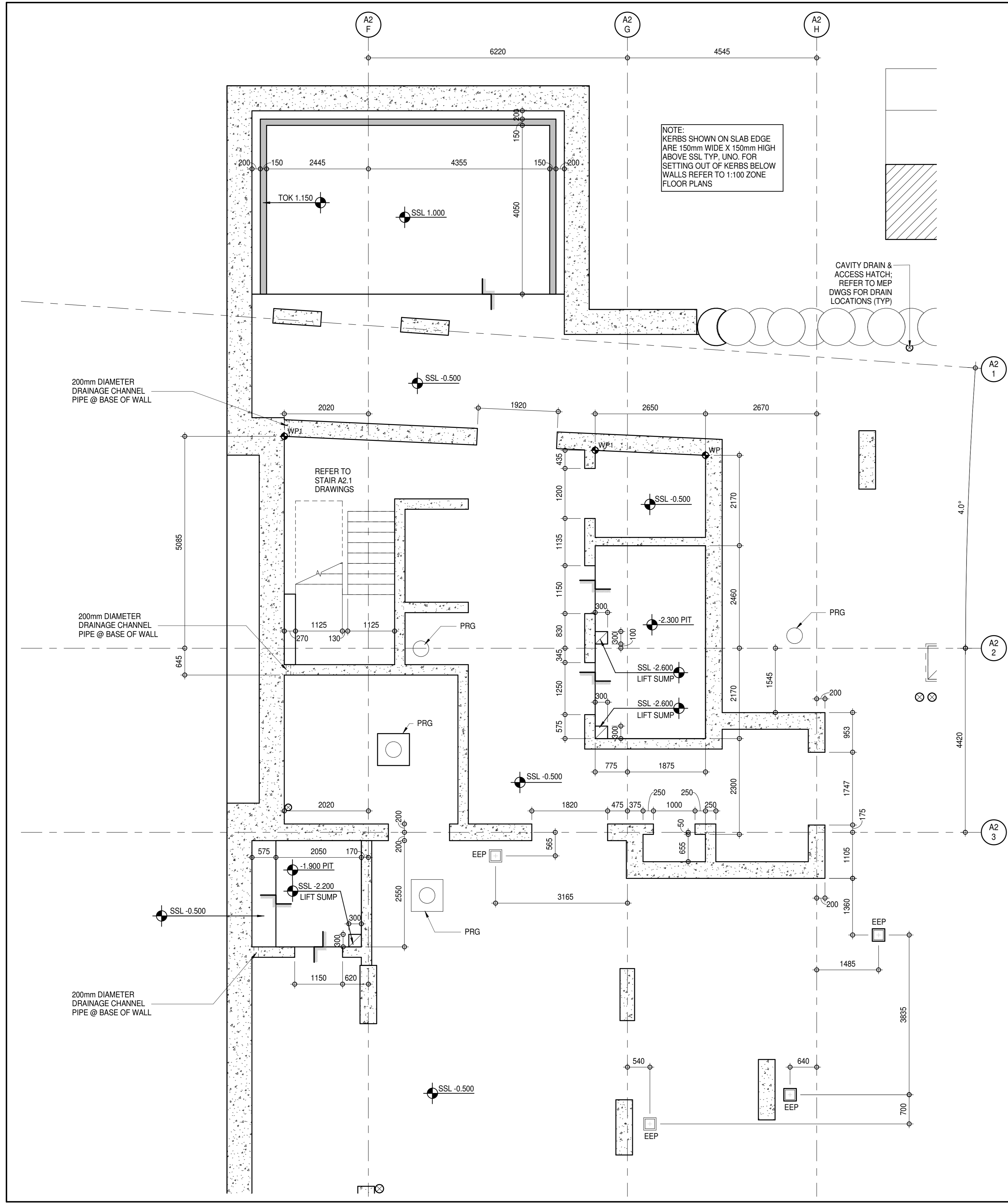

2 B2 LEVEL A2 CORE SLAB EDGE PLAN

6/2/2016 1:14:17 PM
62.702
1:50

1 B2 LEVEL A2 CORE PLAN

FOR INTERIOR FINISHES INFORMATION
REFER TO 67 000 SERIES DRAWINGS

6/2/2016 1:14:17 PM
62.702
1:50

DRAWING TITLE

B2 LEVEL A2 CORE PLAN AND SLAB EDGE PLAN

SCALE @ A0 DRAWN CHECKED DATE

As indicated

GRAPHIC SCALE

PROJECT NO. 1414-00

DRAWING NO. **63 012**

LOCATION 103EW REVISION 04

6/2/2016 1:14:17 PM

